

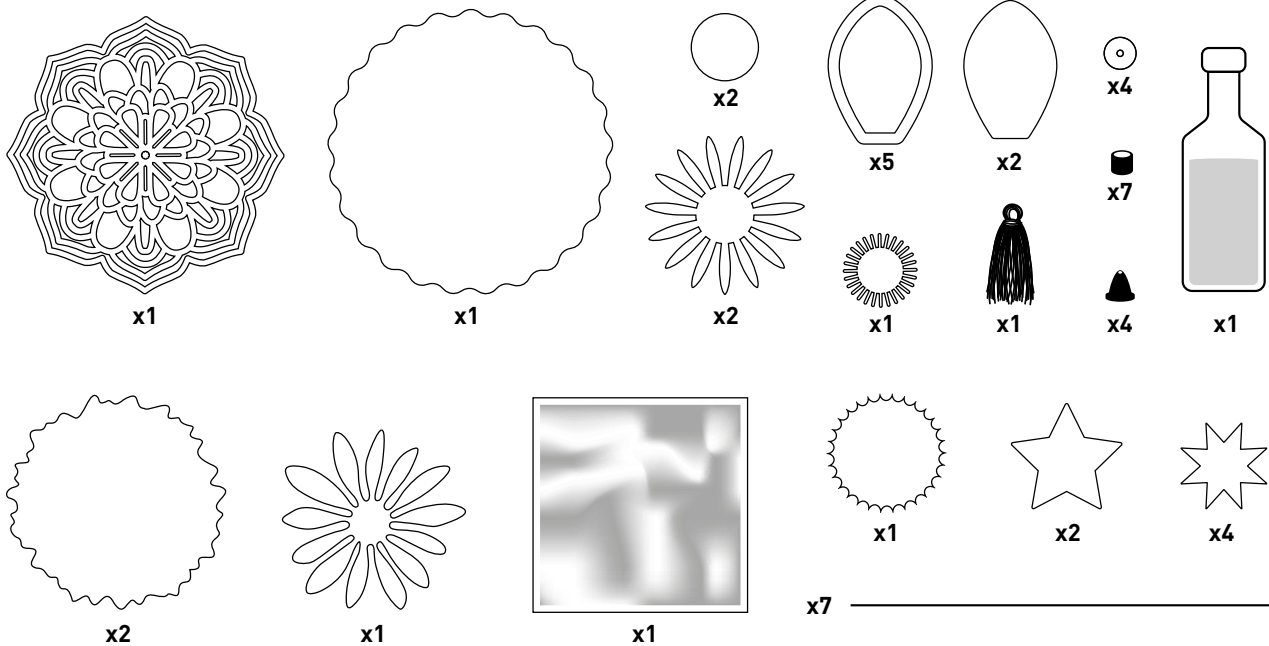

BOX STARRY GARDEN

10

Assembly instructions



Supplied materials

- The pre-cut elements
- The rubber end caps
- A gold leaf.
- A Tassels.
- The metal washers
- The separator elements
- The metal stems
- A bottle with sand

Necessary materials (not supplied)

- A needle
- Round-nose pliers
- Wire cutters
- A tube of glue
- A piece of thick cardboard

Advice

- Start by taking all the items out of the box to familiarize yourself with the contents.
- Handle the cutouts and stems with care.

1

Start by forming a loop at the end of 4 stems using your round-nose pliers.



ASSEMBLY OF THE FIRST FLOWER

2

Stack the 3 elements on top of each other and pierce the center using the needle, placing the shape on a piece of cardboard for support.

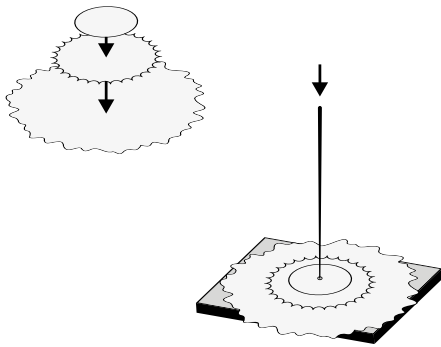

3

Start by sliding the metal washer onto the stem until it reaches the loop.

Next, slide the smallest flower onto the stem, followed by a separator element.

Then, slide the second flower onto the stem, add another separator element, and finally, slide the third flower onto the stem.

Finish by securing everything with the rubber end cap to hold the flowers in place on the stem.

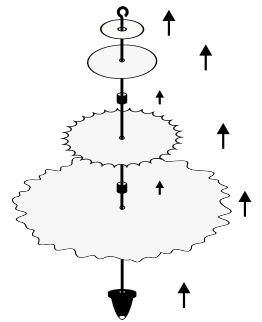

4

Use your round-nose pliers to gently bend the petals of your flower, giving it a natural, lively shape. This will help the flower appear more dynamic and realistic.

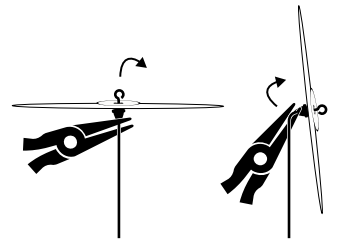

5

Take the 2 petals and your glue tube.

Apply glue to the base of each petal, about 1 cm from the bottom, and press them together. This will help create a more structured, layered look for your flower.

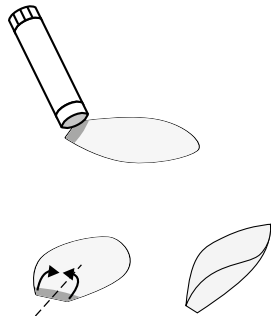

6

Position the petal on the stem and fold the base around the stem using your fingers.

Once the petal is securely in place, you can lay the flower aside and move on to the next one.

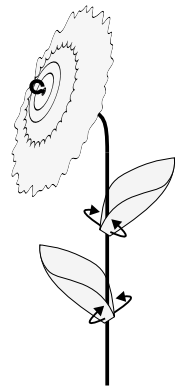

THE STARS

7

Start by gluing the back of the two pre-cut stars.

Take a stem, place it on top of one star, and then stack the second star on top of the first, covering the stem.

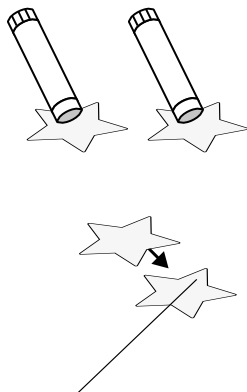

8

Repeat the same process for the other two stars. Once you've finished, you can set your stars aside and move on to the next step.

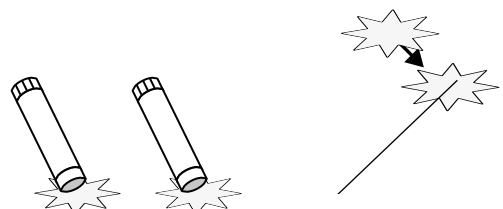

9

Place your pre-cut flower on a piece of cardboard, then pierce the center of the flower using the needle. Take the stem with the loop you formed earlier. Slide the metal washer (sequin) onto the stem until it reaches the loop. Then, slide the flower onto the stem, pushing it down to rest on the washer. Finish by adding the rubber end cap to secure the flower in place on the stem.

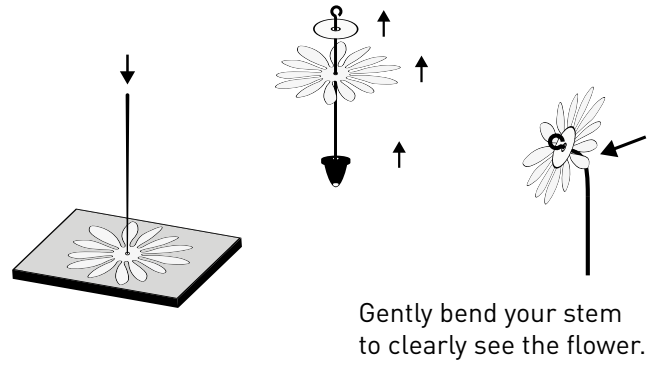

THE GOLD LEAF

10

With these two shapes, apply glue randomly, which will be used to adhere the gold leaf.

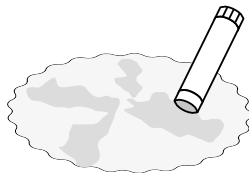
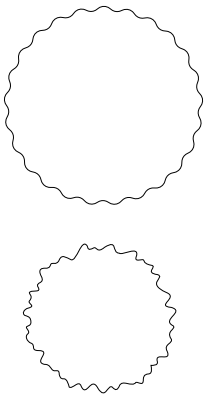

11

Then, place the gold leaf onto the areas you previously applied glue to.

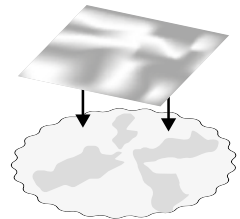

Gather the pieces of your gold leaf and repeat the same process on the other piece.



ASSEMBLY OF THE LARGEST FLOWER

12

Take the 5 elements that will form the crown. Apply a strip of glue to the back and lower part of each shape. Take the remaining small circle and position the five shapes on this circle to form a large flower.

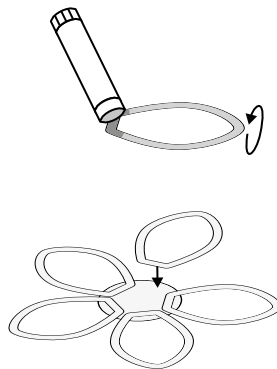

13

Stack the 3 elements on top of each other and pierce the center using the needle, placing the shapes on a piece of cardboard for support.

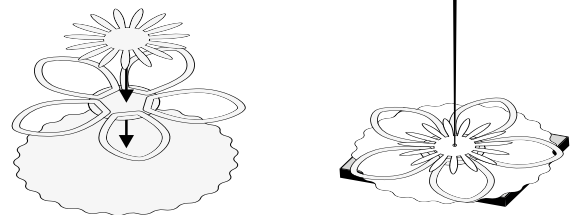

14

Start by sliding the metal washer onto the loop. Slide the smallest flower onto the metal washer. Insert a separator element, then slide the second flower. Insert another separator element, then slide the third flower. Insert a separator element again, then slide the fourth flower. Slide a metal washer last. Finish with the rubber end cap to secure the flower onto the stem.

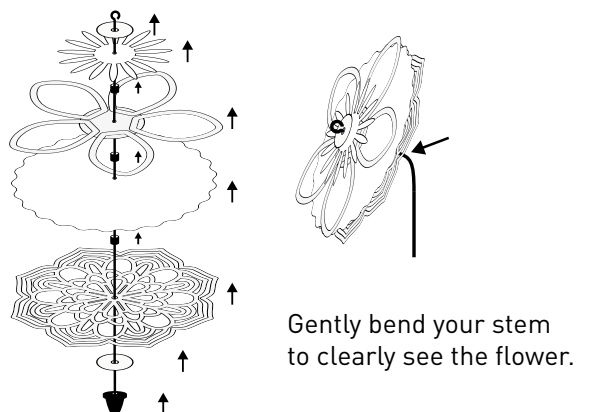

15

Stack the 3 elements on top of each other and pierce the center using the needle, placing the shape on a piece of cardboard for support.

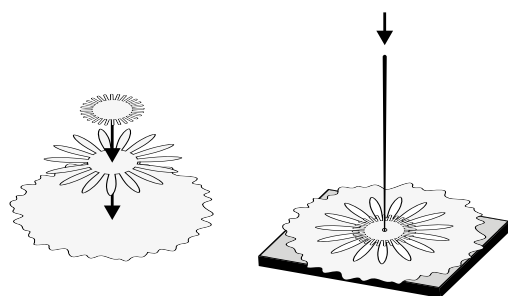

16

Take a stem with a loop.

Using your round-nose pliers, gently open the loop to insert the tassel.

Then, close the loop of the stem with your pliers.

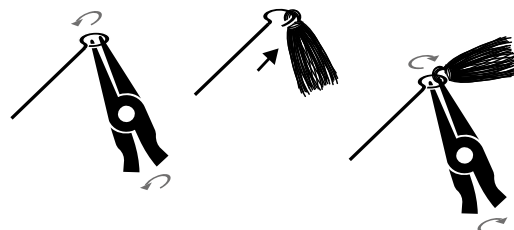

17

Assemble your flower on the stem.

Gently slide the first small flower onto the stem.

Insert a spacer, slide on the second flower, then insert another spacer before sliding on the third flower.

Finish with the rubber stopper to secure the flower on the stem.

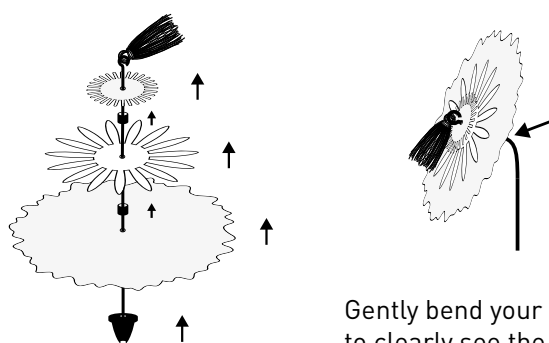

Gently bend your stem to clearly see the flower.

18

You have assembled your bouquet.

Now, it's time to unscrew the cap of the small bottle and place your beautiful arrangement inside.

Additional Notes

- Use wire cutters to adjust the height of your stems to your desired length.

